

# Lambourn Neighbourhood Development Plan

Your Parish, Your Plan

Photo credits:MBJ

## LAM1 - Land between Folly Road, Rockfel Road & Stork House Drive, Lambourn

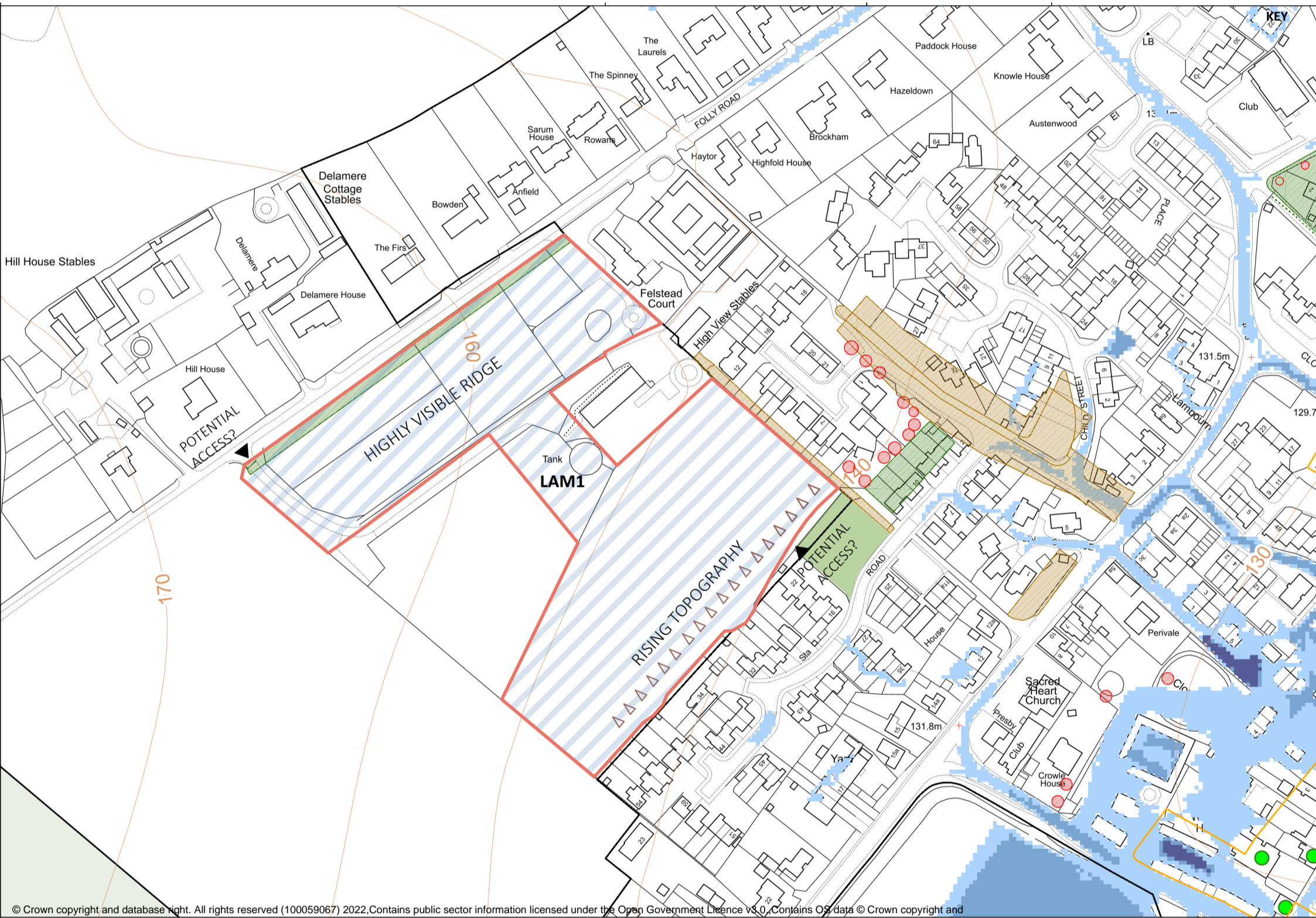









**Size-** 3.05 ha

**Number of Dwellings proposed-**

24 units

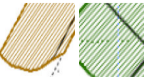
### Key

- |   |                                       |   |                                    |   |                           |
|---|---------------------------------------|---|------------------------------------|---|---------------------------|
|  | Green Space to be retained / replaced |  | Surface water flooding - Low risk  |  | Grade II Listed Building  |
|  | Individual TPO                        |  | Surface water flooding - Med risk  |  | Grade II* Listed Building |
|  | Group TPO                             |  | Surface water flooding - High risk |  | Conservation Area         |